

# first floor

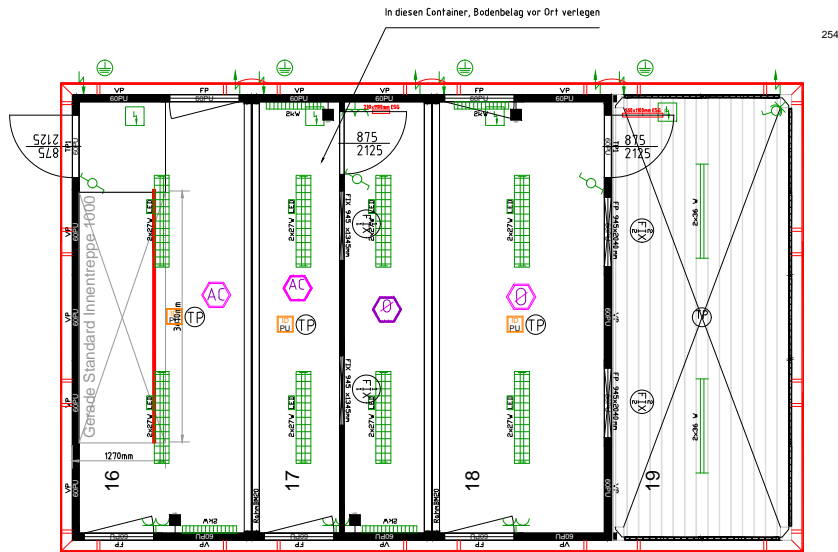

# ground floor

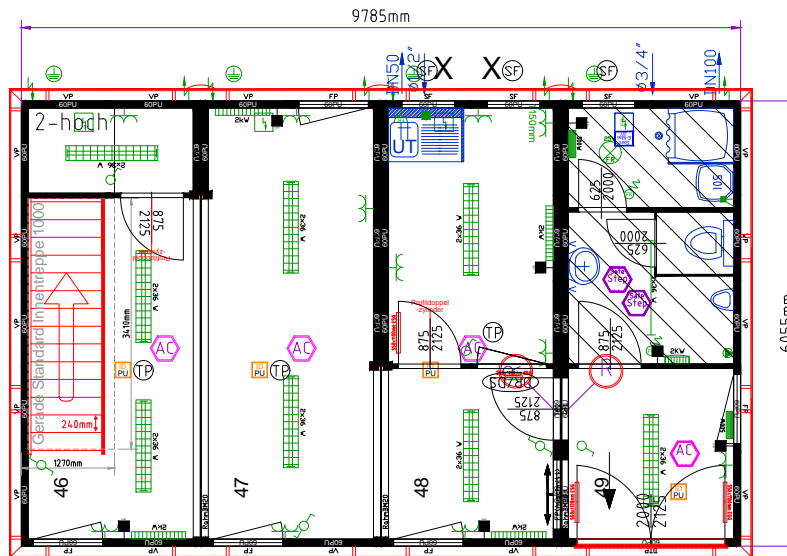

Modular building consisting of:  
 cabins: 8x20'  
 internal height: 2340 mm  
 colour: R: RAL 7035 P:RAL 7035

- Electric GB (230V/32A/3-poles)
- Internal finish: white
- floor to window frame height: 870mm
- Gas filled window
- Cement-bound chipboard floor
- Forklift pocket distance: 1660 mm
- Floor insulation: 60 mm mineral wool
- PU-panels (60 mm)
- Roof insulation: 100 mm mineral wool
- Ground floor: Rauminnenhöhe: 2340mm
- 1st floor: Rauminnenhöhe: 2540mm  
Floor to window frame height: 1030 mm

9356298-006.dwg

- Transpack (flatpacked) version
- steel sheet version (complete)
- X...Sanitär Fenster mit Klarglas
- Mipolam Accord 300
- Safestep flooring - including skirting
- without PVC - flooring  
without plinths
- door linking kit for modular buildings (without frame)
- internal doors with cylinder
- Corner trims with magnetic clamps
- incl. skirting
- Alu roller shutter
- neutralised
- Totra pipework (GB)
- Shower with catcher ring (GB)
- Distribution box with PVC cover
- flexible cable system
- Ground floor: — Attic RAL 7035
- 1st floor: — Attic RAL 6005
- ...LED lighting